

All rights reserved. Specifications subject to change without notice.

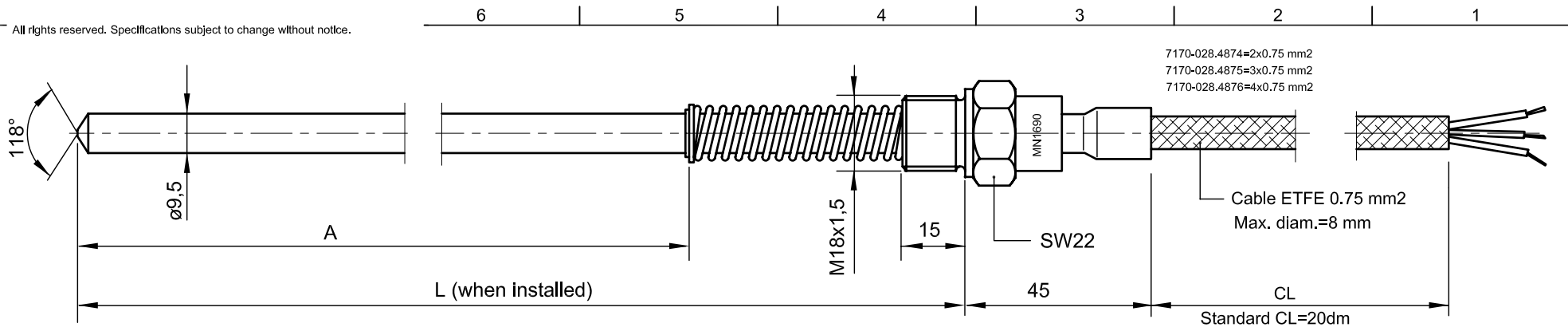

7170-028.4874=2x0.75 mm2
 7170-028.4875=3x0.75 mm2
 7170-028.4876=4x0.75 mm2

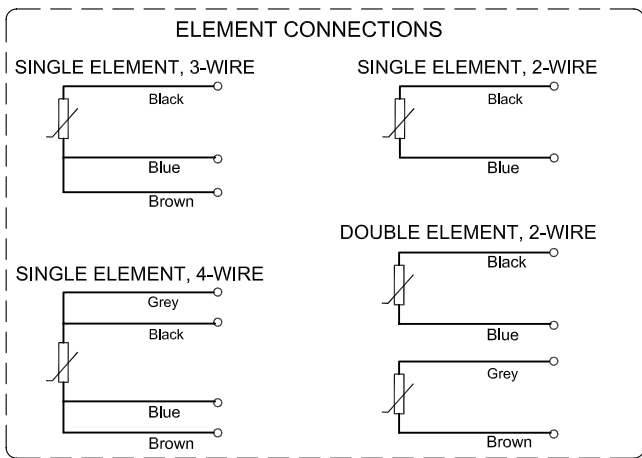

ENGINE	A	L
PA6	115	180
PC2 and PC2,5	190	255
PC3	280	345
PC4	300	365
SULZER AV25/30	105	170
MITSUI V42M	10	75
MITSUI V42M	155	220
	20	85
PC2,6	210	275
	160	225
WARTSILA	40	105
SWD 8213/R571	88	153

LETTER NO.2	ELEMENT TYPE	RANGE
U	Pt100 Ohm/0 °C	-50 to 150 °C

LETTER NO.1	EXPLANATION
D	Double element, 2-wire
S	Single element, 2-wire
T	Single element, 3-wire
F	Single element, 4-wire

ORDERING EXAMPLE: MN1690 T 180 U 30

Mechanical design _____
 3-wire connection (Letter no.1) _____
 Length of temp. sensor in mm _____
 Element type Pt100 (Letter no.2) _____
 (CL) Cable length in decimeter _____

F	4-wire inn. 110892 AK/E.S.	H	Letter V out. 030707, VRa/AJK
E	Omlegn. 181090 S.R./AK	G	2-wire inn. 950817 AJK/V
Rev.	Zone	Rev.	Zone
	Description		Description
	Date/Sign.		Date/Sign.

Date	18.10.90	Dsgn/Dwn	AJK/SR	Trac		Scale	1:1 [A3]
Checked	JS	Spec Ctrl.		Approved	AJK		

S.tegn.MN-1807

Kongsberg Maritime AS
Automation
Trondheim

Ref.	Next sheet
Dwg no.	Sh.no. Rev.
MN-1690	H

Temperature sensor type MN1690-

DIMENSIONAL SKETCH